

Product Highlights

- Non-combustible metal cladding and roofing profile
- Versatile design and install options available
- Strong shadow line with concealed fixings
- Ability to curve and taper panels
- 50mm rib standing seam product comes with clip relief in the pan of the panel

Product Specifications

Rib Heights available	25mm, 38mm and 50mm * rib heights available
Length of Panel	Panel lengths available from a minimum 500mm, dependant on material selection
Cover Widths available	180mm – 530mm pan widths from rib to rib (material dependant)
Substrate Requirements	Substrate options available for wall and roof applications ** For best finish 15mm construction grade plywood on walls, and 19mm construction grade on roof.
Tolerance (mm)	Sheet length: +/- 7mm Covering width: +/- 7mm
Minimum Roof Pitch Required	3° Degrees
Stop End and/or Hook	Recommended by ACS
Fire Rated/BAL Applications	Suitable for use in fire rated and BAL applications in conjunction with a suitable wall/roof build up *

* Note: 50mm product has clip relief in the pan of the panel

** Note: For further information and expert advice please contact Architectural Cladding Suppliers.

Standing Seam.

Brands

COLORBOND® steel
GALVABOND® steel
ZINCALUME® steel
RHEINZINK®
PREFA Aluminium
Aurubis
elZinc®
VMZINC®
Unicote®, Unicote® Lux
MagnaFlow, ColorCote® & UniZinc™

Metals

Steel, Aluminium, Copper, Brass,
Weathering Steel, Galvanised Steel,
Titanium Zinc, Stainless Steel



Key Benefits

- Suited for residential and commercial building.
- Custom rib heights allow for various depth in shadow lines.
- Custom pan widths available to suit design requirements.
- Ability to curve and taper panels.
- Double lock standing seam optional – recommended in areas where extreme weather conditions occur.
- Minimal maintenance compared to other building materials.
- Versatile design and install options available.
- Allows for building expansion and contraction.



Technical Support

- Architectural Cladding Suppliers are here to help you. We can manufacture and provide everything that is required to complete your project from our cladding profiles, to all the associated accessories and flashings via our sister company, PPC Flashings. For further information or support with flashings please contact the PPC Flashings team.
- As every architectural project is different, if you require custom advice, we can discuss your project specifications and will work with you to fabricate to your individual requirements. For any further technical support please contact Architectural Cladding Suppliers.

Installation

- Architectural Cladding Suppliers cannot guarantee that your metal panels will not experience the effects of what is commonly referred to as oil canning. Oil canning can occur on all types of metal and is not considered a panel defect. For more information please refer to our [website article on oil canning](#).
- We recommend installing a "breathable vapour" membrane to act as a second line of defence to stop any water ingress as well as allowing the building to "breathe". Any flashings required can be sourced via PPC Flashings.
- Stop ends and/or hooks to each panel are highly recommended by Architectural Cladding Suppliers. If you are unsure, please contact us prior to ordering.
- When using a metal tophat the minimum thickness requirement is to be no less than 0.55 BMT.
- Architectural Cladding Suppliers recommend that any of our cladding products are installed by a qualified and experienced cladding installer for best results. Do not continue if the installation does not seem right, contact Architectural Cladding Suppliers.



25/38mm

Standing
Seam



50mm

Standing
Seam



GENERAL DISCLAIMER:

Architectural Cladding Suppliers recommend that any of our cladding products are installed by a qualified and experienced cladding installer for best results. Our ACS datasheet is to be used as a guide only and for further technical support or advice, please contact our cladding team, prior to placing your order or any installation works.

Assembly Instruction

Standing Seam Panel

Nom. Cover Dimension

Scale 1:20

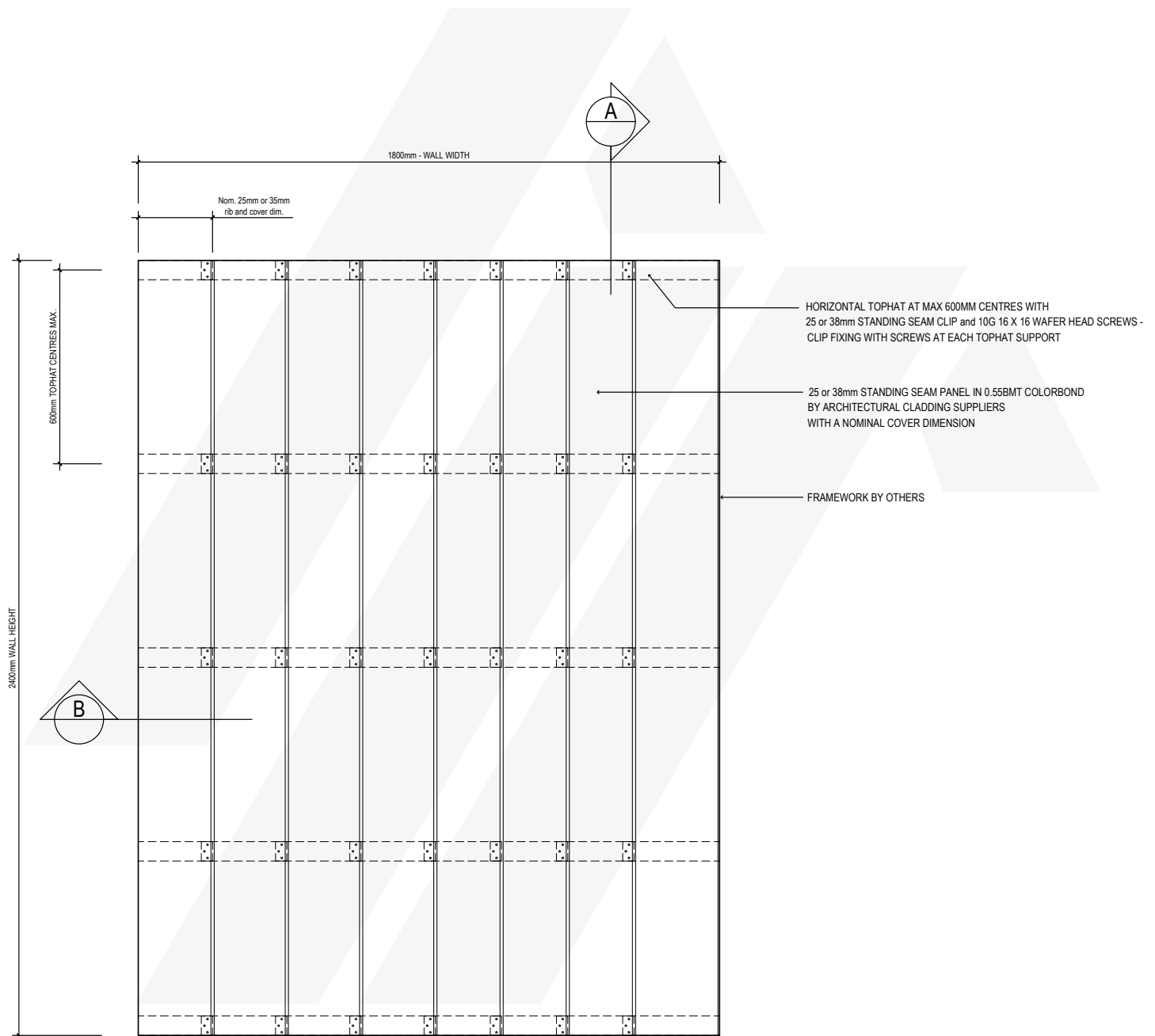

Assembly Instruction

Section A

Not to scale

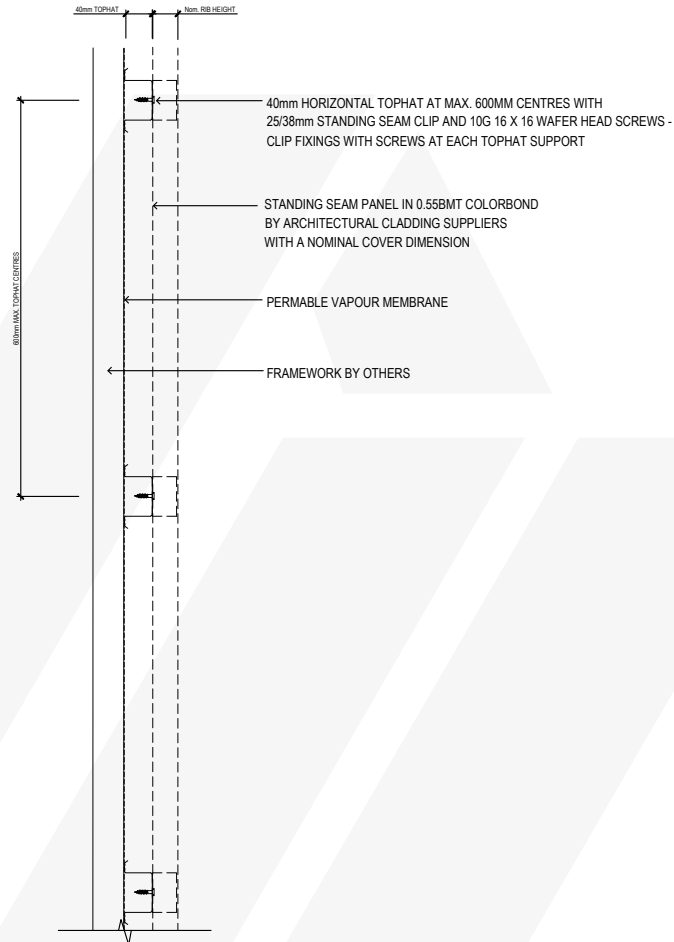

Section B

Not to scale

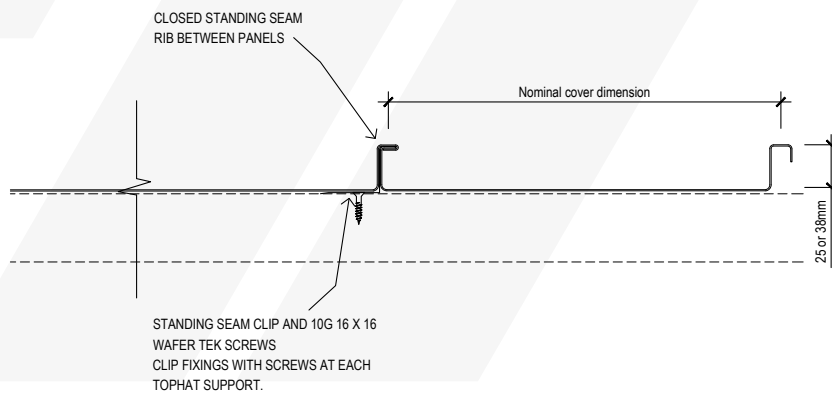

PLEASE NOTE:

The nominated 40mm tophat is a guide only, and height of tophat depends on the wall build up requirements and is not determined by ACS.